



# 5/8" BORE STAINLESS STEEL CYLINDER

## FSR-10-□-□

Single Acting



**Mount:** Front      **Standard Stroke Lengths:** 1/2", 1", 1-1/2", 2", 3", 4"  
**Type:** Rotating Rod      **Spring Compressed:** 4 lbs. **Spring At Rest:** 1.3 lbs. For B option add 0.375  
**Options:** M, B, H, V, S, N, W **Maximum Stroke:** 13"      For M option add 0.312

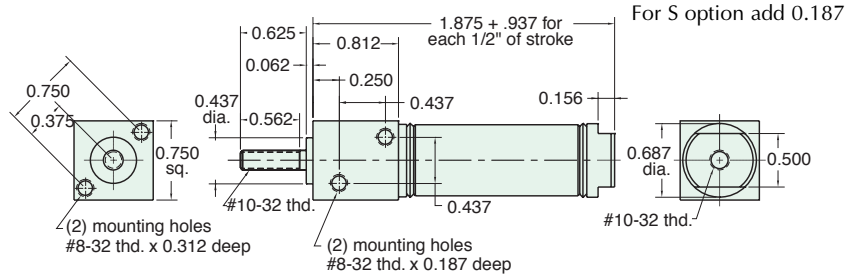

Furnished without nut(s). See Chart on Page 18.

## FDR-10-□-□

Double Acting



**Mount:** Front      **Standard Stroke Lengths:** 1/2", 1", 1-1/2", 2", 3", 4"  
**Type:** Rotating Rod      **Maximum Stroke:** 43"  
**Options:** M, B, V, P6, P7, P8, S, N, W      For B option add 0.500  
For M option add 0.312

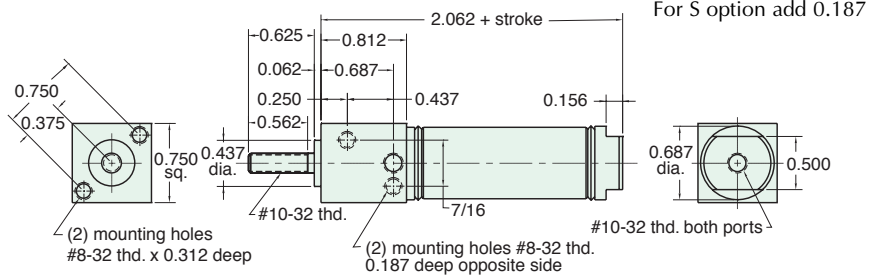

## SDR-10-□-□

Double Acting



**Mount:** Stud      **Standard Stroke Lengths:** 1/2", 1", 1-1/2", 2", 3", 4"  
**Type:** Rotating Rod      **Maximum Stroke:** 43"  
**Options:** M, B, V, P6, P7, P8, S, N, W      For B option add 0.500  
For M option add 0.312

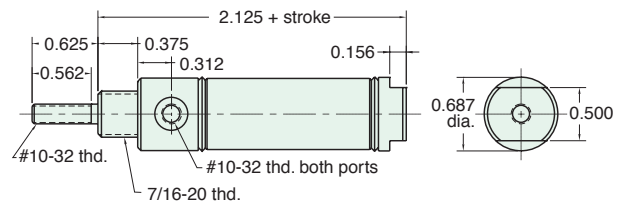

Nut included, but not shown on drawing

## UDR-10-□-□

Double Acting



**Mount:** Universal      **Standard Stroke Lengths:** 1/2", 1", 1-1/2", 2", 3", 4"  
**Type:** Rotating Rod      **Maximum Stroke:** 43"  
**Options:** M, B, V, P2, P3, P4, P5, P6, P7, P8, N, W      For B option add 0.500  
For M option add 0.312

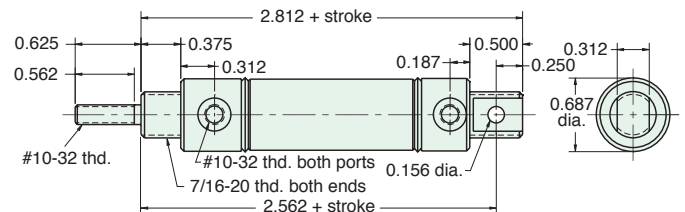

Furnished without nut(s). See Chart on Page 18.